

# CROSSHEAD ECM100-C

MANUAL & SELF-CENTERING CO-EXTRUSION

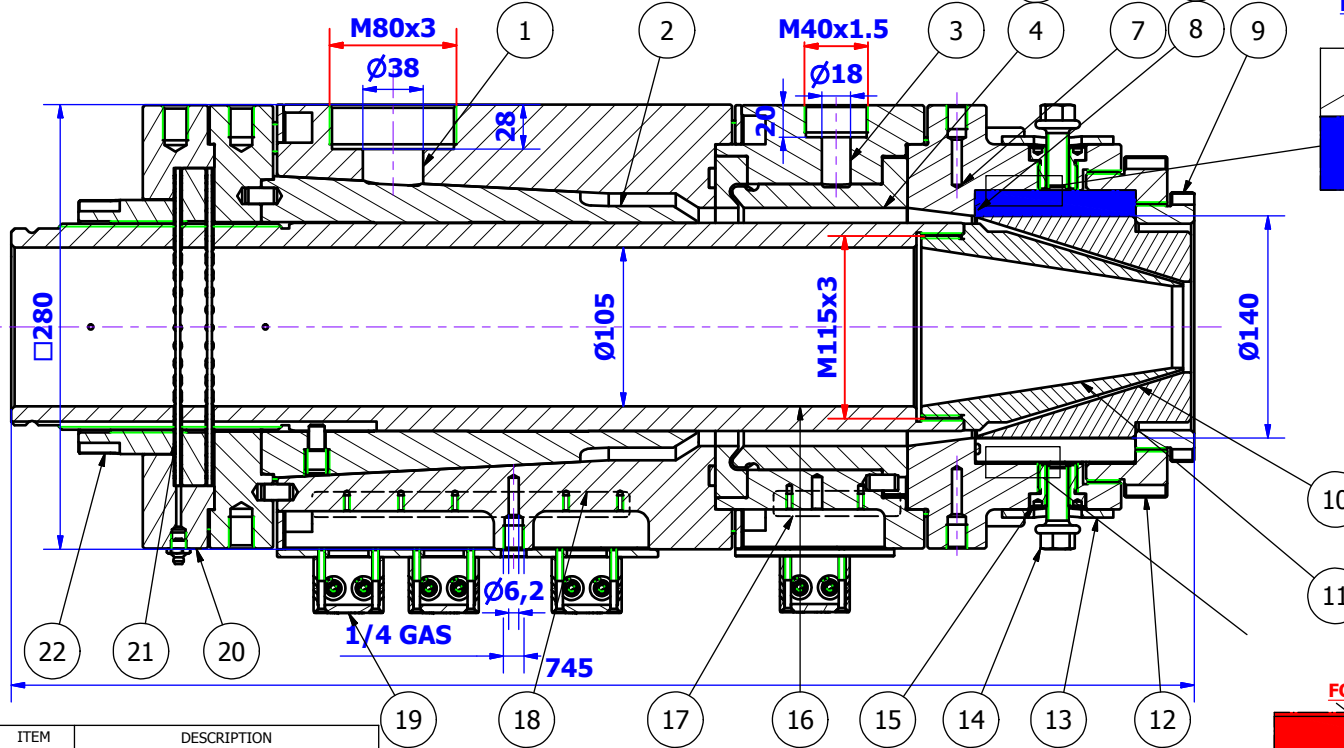

CALIBRATED COUPLING  
DIE HOLDER FOR SELF CENTERING  
EXCLUDES CENTERING SCREW

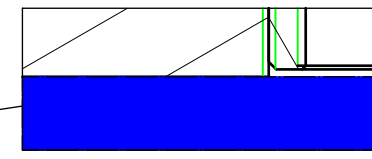

| APPLICATIONS |              |
|--------------|--------------|
|              | SINGLE LAYER |
|              | STRIPE       |
|              | SKIN         |

Ø MAX CONDUCTOR: 100mm  
Ø MAX DIE: 110mm

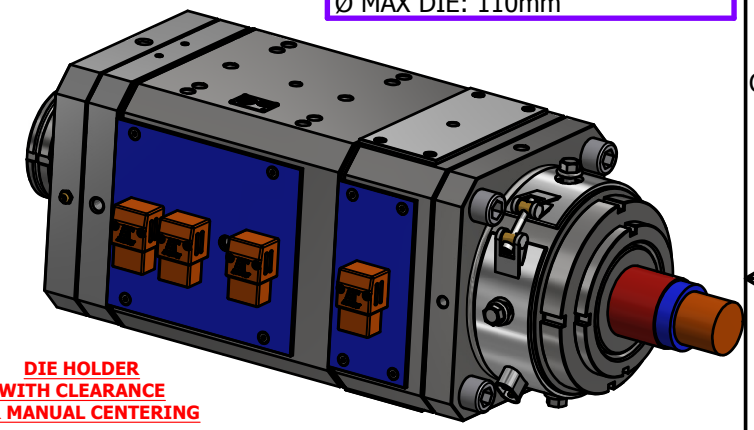

DIE HOLDER  
WITH CLEARANCE  
FOR MANUAL CENTERING

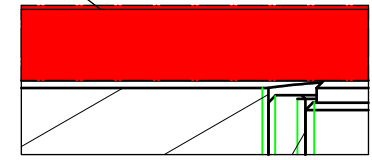

**ELECTRICAL POWER (HEAD BODY ZONE): 220V 6400W**  
**ELECTRICAL POWER (CO-EXTRUSION ZONE): 220V 2000W**  
**ELECTRICAL POWER (DIE AREA): 220V 1000W**

| ITEM | DESCRIPTION                          |
|------|--------------------------------------|
| 1    | HEAD BODY                            |
| 2    | CARTRIDGE                            |
| 3    | HOLDING RING PLATE                   |
| 4    | RING FOR SKIN                        |
| 5    | RING FOR STRIPE                      |
| 6    | NEUTRAL RING                         |
| 7    | FRONT PLATE                          |
| 8    | HOLDING DIE FOR MANUAL CENTERING     |
| 8A   | HOLDING DIE FOR SELF-CENTERING       |
| 9    | HOLDING NUT FOR HOLDING DIE          |
| 10   | DIE                                  |
| 11   | TIP                                  |
| 12   | ADJUSTING DIE NUT                    |
| 13   | BAND HEATER 220V 1000W               |
| 14   | CENTERING SCREWS                     |
| 15   | BUSHES                               |
| 16   | HOLDING WIRE-GUIDE                   |
| 17   | H. CARTRIDGES 220V 8x500W            |
| 18   | H. CARTRIDGES 220V 8x800W            |
| 19   | POWER CONNECTOR                      |
| 20   | THRUST BEARING PLATE                 |
| 21   | BALL BEARING                         |
| 22   | ADJUSTING NUT FOR HOLDING WIRE-GUIDE |



## CROSSHEAD ECM100-C

EUROTEK S.r.l.  
66034 LANCIANO (Ch)- Italy  
Phone:(+39) 0872 72581 FAX:(+39) 0872 711978  
www.eurotek-italy.it  
E-mail: info@eurotek-italy.it

