

# CROSSHEAD ECM60/DS

MANUAL CENTERING DOUBLE LAYER

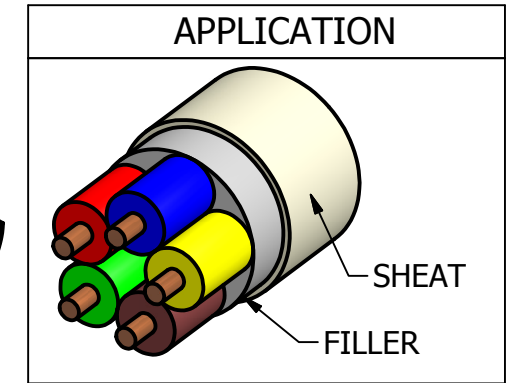

MAX CONDUCTOR: 60mm  
 MAX Ø OVER INSULATION: 70mm  
 MAX PASSAGE DIE: 85mm

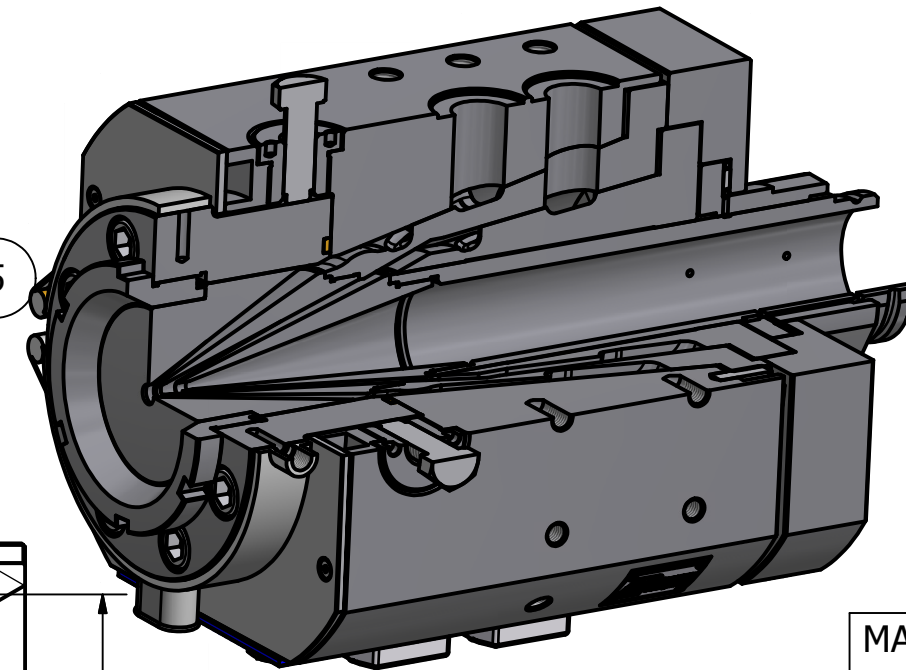
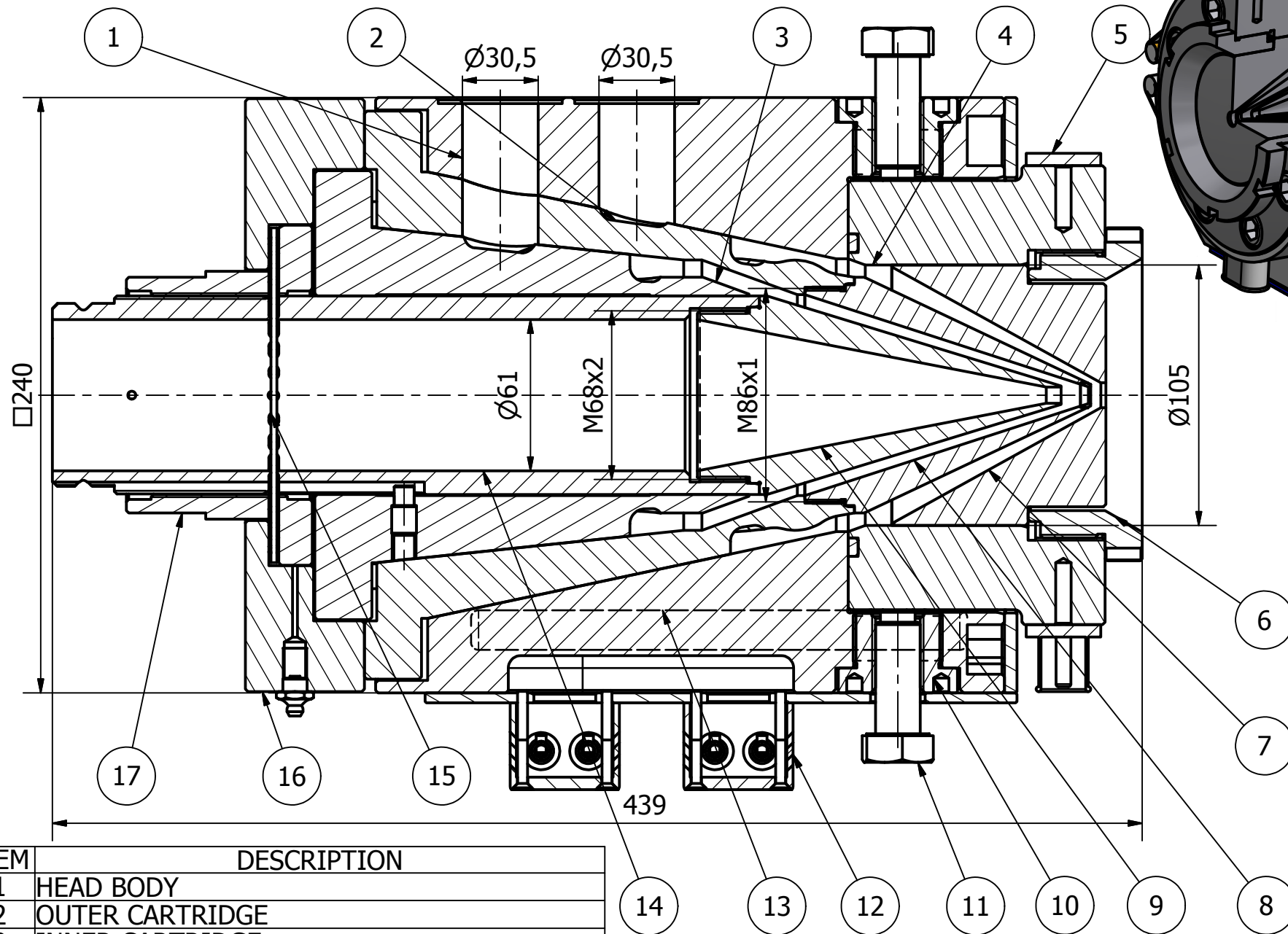
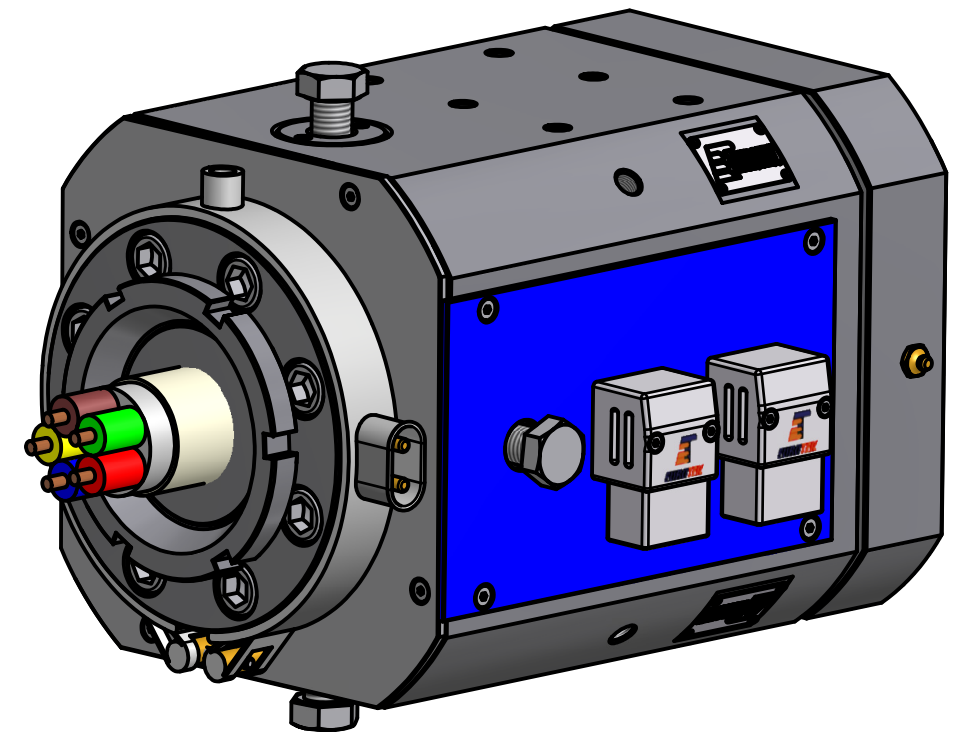

ITEM	DESCRIPTION
1	HEAD BODY
2	OUTER CARTRIDGE
3	INNER CARTRIDGE
4	MANUAL HOLDING DIE
5	HEATER 300W
6	HOLDING DIE NUT
7	BOTTOM DIE
8	INTERMEDIATE DIE
9	TIP
10	BUSHES
11	CENTERING SCREW
12	POWER CONNECTOR
13	H. CARTRIDGE 6400W
14	HOLDING WIRE-GUIDE
15	BALL BEARING
16	THRUST BEARING PLATE
17	ADJUSTING NUT FOR HOLDING WIRE-GUIDE

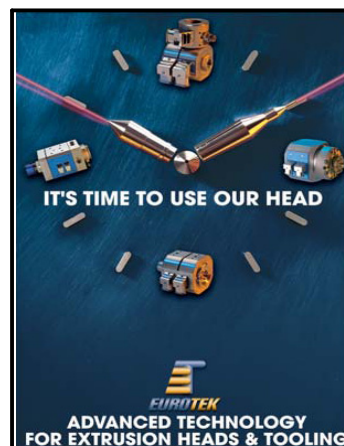

## CROSSHEAD ECM60/DS

EUROTEK S.r.l.  
 66034 LANCIANO (Ch)- Italy  
 Phone:(+39) 0872 72581 FAX:(+39) 0872 711978  
 www.eurotek-italy.it  
 E-mail: info@eurotek-italy.it

